



FOR LEASE SQUARE FOOTAGE INFORMATION

ADDRESS
W. PAULINE WHITAKER
PKWY & S. J.B. HUNT DR
ROGERS, AR

UNDER CONSTRUCTION OR PLANNED	RETAIL & RESTAURANT SF	CLASS "A" OFFICE SF	TOTAL SF
DMU 1	13,250	25,750	39,000
DMU 2	18,000	45,000	63,000
DMU 3 & 4	7,000	2,500	9,500
DMU 5	24,250	34,000	58,250
PLAZA RESTAURANT 1	3,500		3,500
PLAZA RESTAURANT 2	4,500		4,500

COMPLETED SQUARE FOOTAGE	RETAIL & RESTAURANT SF	CLASS "A" OFFICE SF	TOTAL SF
RETAIL 1	23,687		23,687
RETAIL 2	15,228		15,228
DOB 1		30,516	30,516
DOB 2		43,377	43,377
DOB 3		40,607	40,607





DEMOGRAPHIC INFORMATION

5 MILE RADIUS
10 MILE RADIUS

KEY FACTS

- POPULATION**
110,754 | 196,230
- MEDIAN AGE**
33.7 | 33.4
- AVG HOUSEHOLD INCOME**
\$100,936 | \$95,306

BUSINESS

- TOTAL BUSINESSES**
5,235 | 10,042
- TOTAL EMPLOYEES**
61,713 | 136,497

HOUSING STATS

- HOUSEHOLDS**
40,253 | 92,858
- MEDIAN HOUSING VALUE**
\$223,477 | \$206,309

Demographic information is provided by [CoStar.com](https://www.costar.com) as of February 2022 and are based on 2021 data.





THE DISTRICT

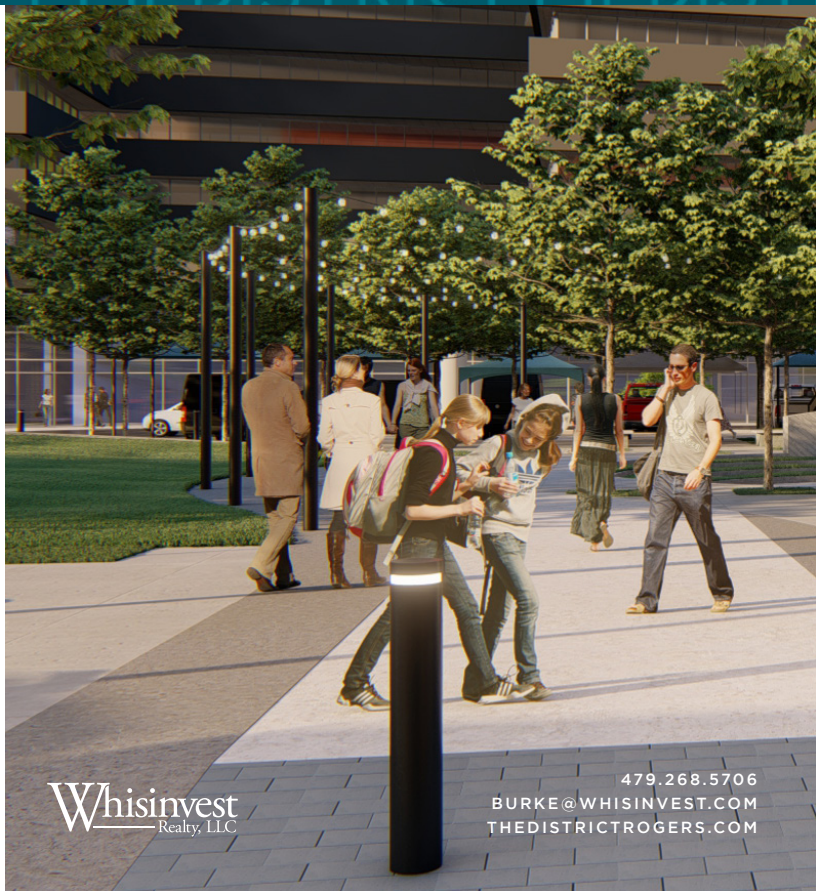

Whisinvest
Realty, LLC

479.268.5706
BURKE@WHISINVEST.COM
THEDISTRICTROGERS.COM